



Dual Polarized Horn Antenna  
15 dBi Gain, 50GHz-75GHz Frequency Range

## Dual Polarized Horn Antenna Data

**MT-DPHA5075-15**

### Features

- Full V Band Performance
- Dual Polarization
- High Port Isolation
- Precisely Machined and Gold Plated

### Description

The **MT-DPHA5075-15** from Microtech is a full-band, dual-polarized, WR-15 horn antenna assembly that operates in the frequency range of 50 GHz to 75 GHz. The antenna features an integrated orthogonal mode converter that provides high port isolation. The MT-DPHA5075-15 supports vertical and horizontal waveguide orientations and has a typical 35 dB cross-polarization suppression, a nominal gain of 15 dBi at the center frequency, a typical 3db beamwidth of 28 degrees in the E-plane, a typical 3db beamwidth of 33 degrees in the H-plane. The input to the antenna is a WR-15 waveguide with a UG-387/U-M threaded flange.

### Specifications

MT-DPHA5075-15		
Item	Specification	Units
Frequency Range	50-75	GHz
Gain	15	dBi
VSWR	1.4:1	
Polarization	Dual	
Horizontal 3dB Beam Width	33	Degrees
Vertical 3dB Beam Width	28	Degrees
Port Isolation	45	dB
Waveguide Size	WR-15	
Flange Designation	UG-385/U	
Size	27.90*56.00	mm
Weight	118	g
Body Material and Finish	Cu, Gold	



**Dual Polarized Horn Antenna Data**

**MT-DPHA5075-15**

**Outline Drawing**

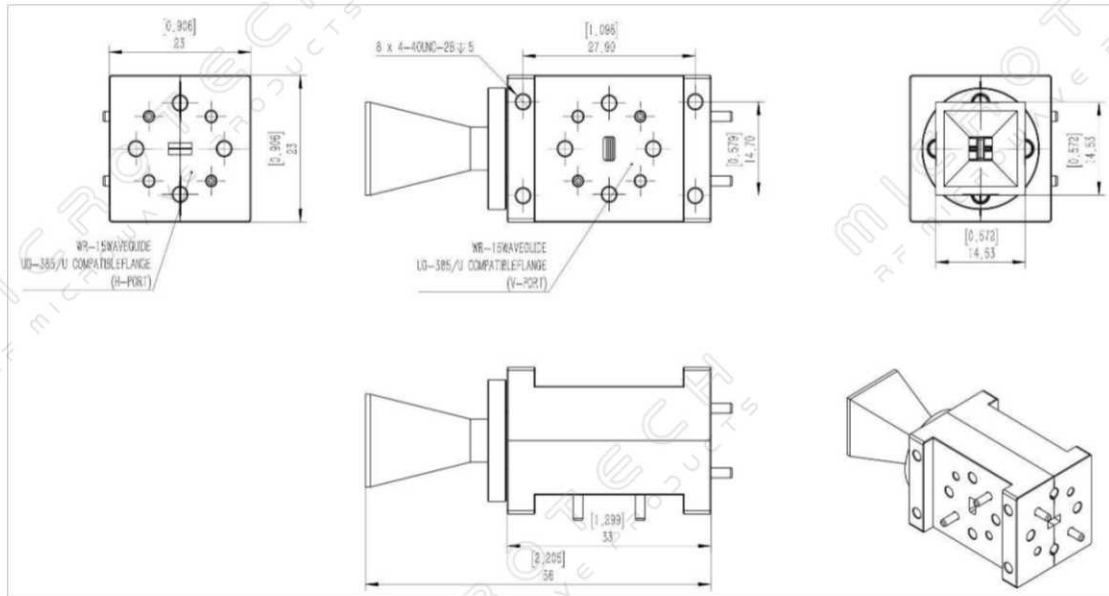

**Testing Result**

**VSWR**

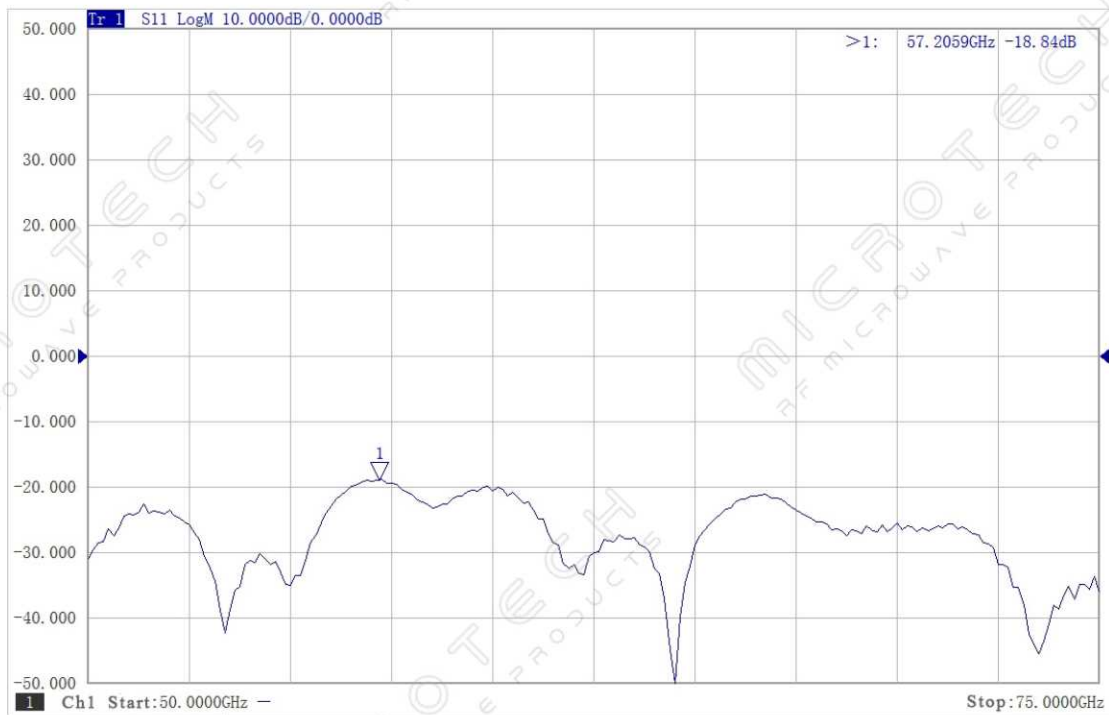



Dual Polarized Horn Antenna  
15 dBi Gain, 50GHz-75GHz Frequency Range

**Dual Polarized Horn Antenna Data**

**MT-DPHA5075-15**

**Simulated Data**

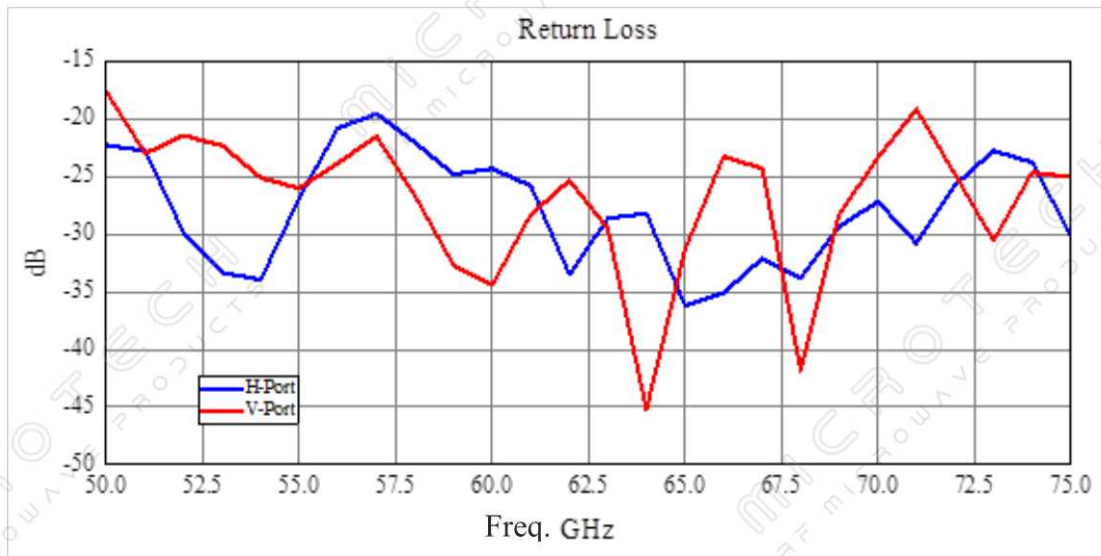
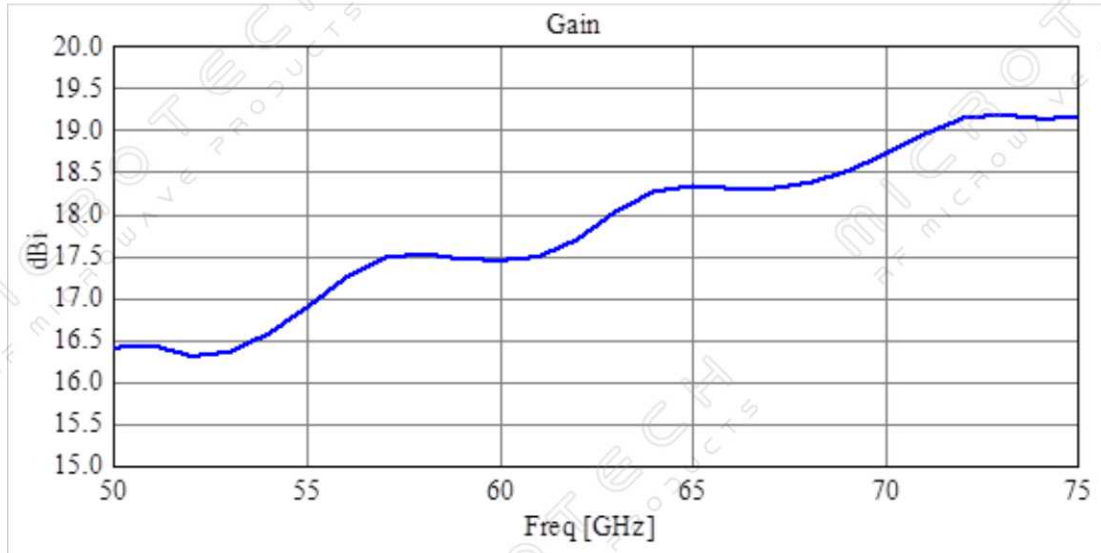



Dual Polarized Horn Antenna  
15 dBi Gain, 50GHz-75GHz Frequency Range

**Dual Polarized Horn Antenna Data**

**MT-DPHA5075-15**

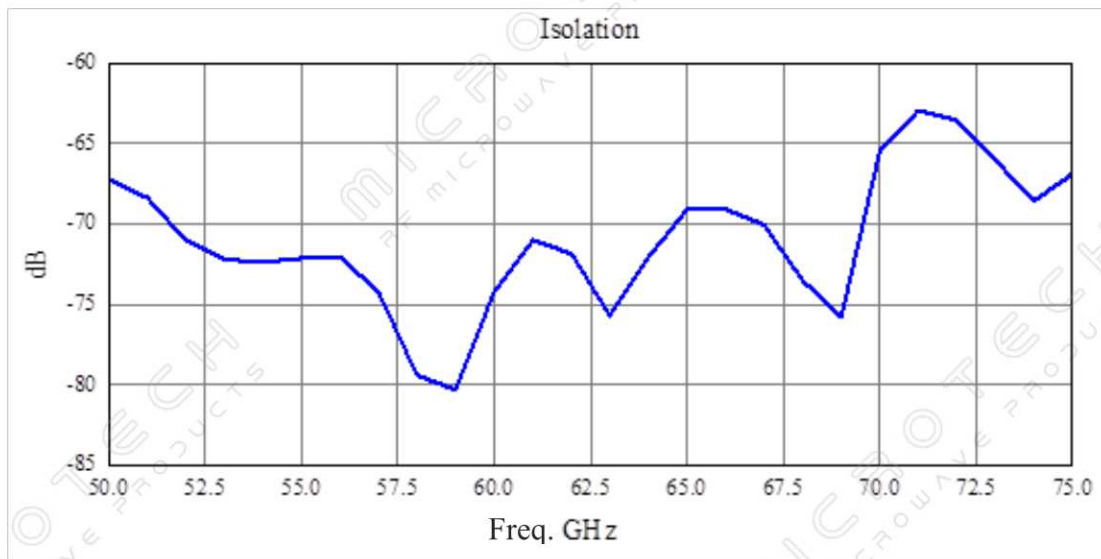
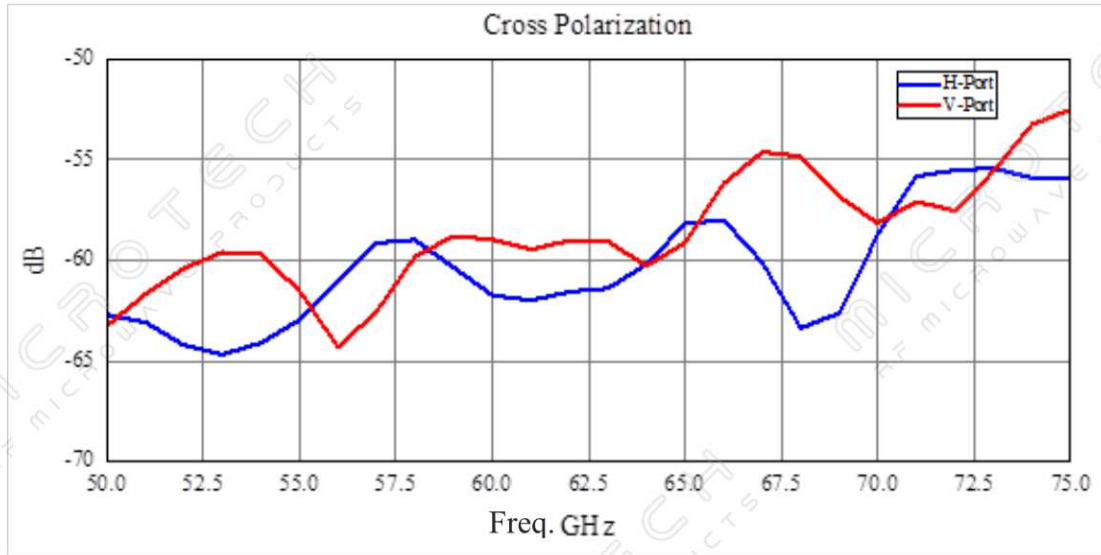





Dual Polarized Horn Antenna  
15 dBi Gain, 50GHz-75GHz Frequency Range

**Dual Polarized Horn Antenna Data**

**MT-DPHA5075-15**

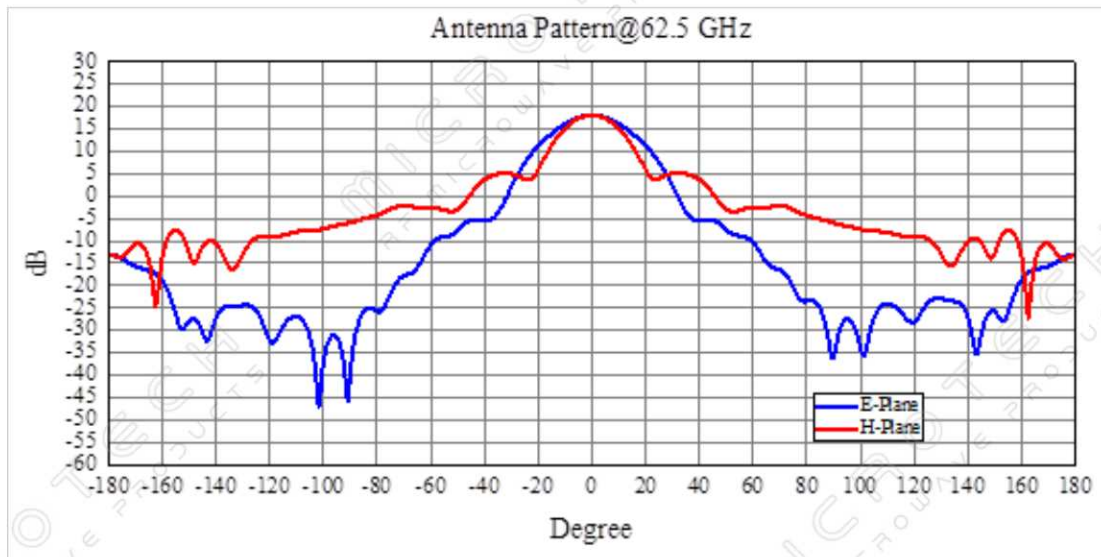
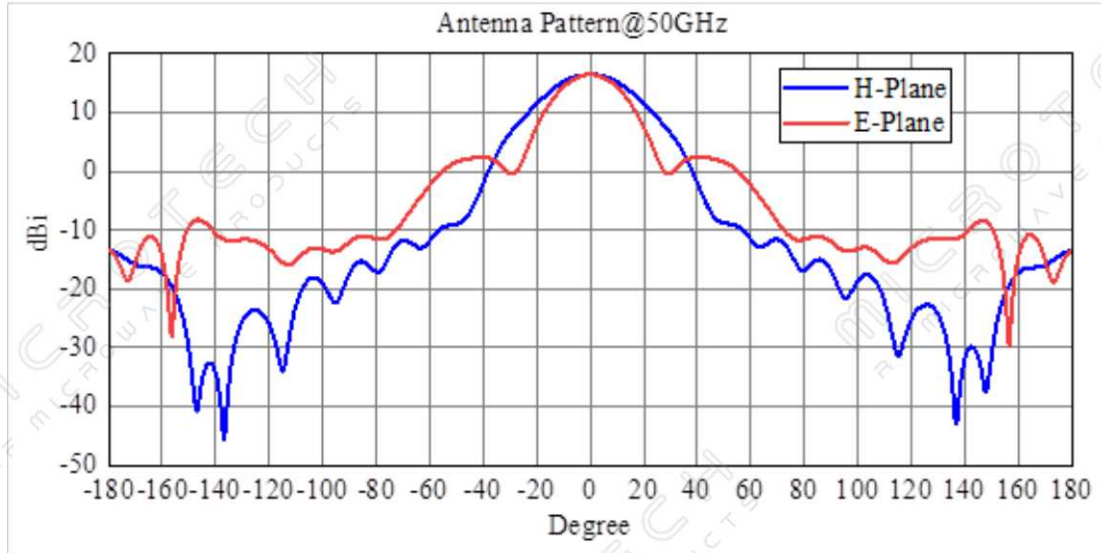



Dual Polarized Horn Antenna  
15 dBi Gain, 50GHz-75GHz Frequency Range

**Dual Polarized Horn Antenna Data**

**MT-DPHA5075-15**

