

*Ku band Omni-Directional Antenna
4 dBi Typ. Gain, 10.7-14.5GHz Frequency Range*

Bi-conical Antenna Data Sheet

RM-BCA107145-4

Specifications

RM-BCA107145-4		
Item	Specification	Units
Frequency Range	10.7-14.5	GHz
Gain	4 Typ.	dBi
VSWR	1.2 Typ.	
Polarization	Vertical	
Connector	N Female	
Size(L*W*H)	Ø76*71(±5)	mm
Weight	About 0.157	kg

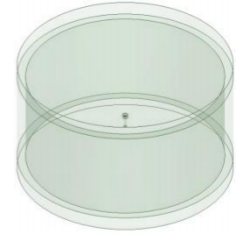

Ku band Omni-Directional Antenna
4 dBi Typ. Gain, 10.7-14.5GHz Frequency Range

Bi-conical Antenna Data Sheet

RM-BCA107145-4

Outline Drawing

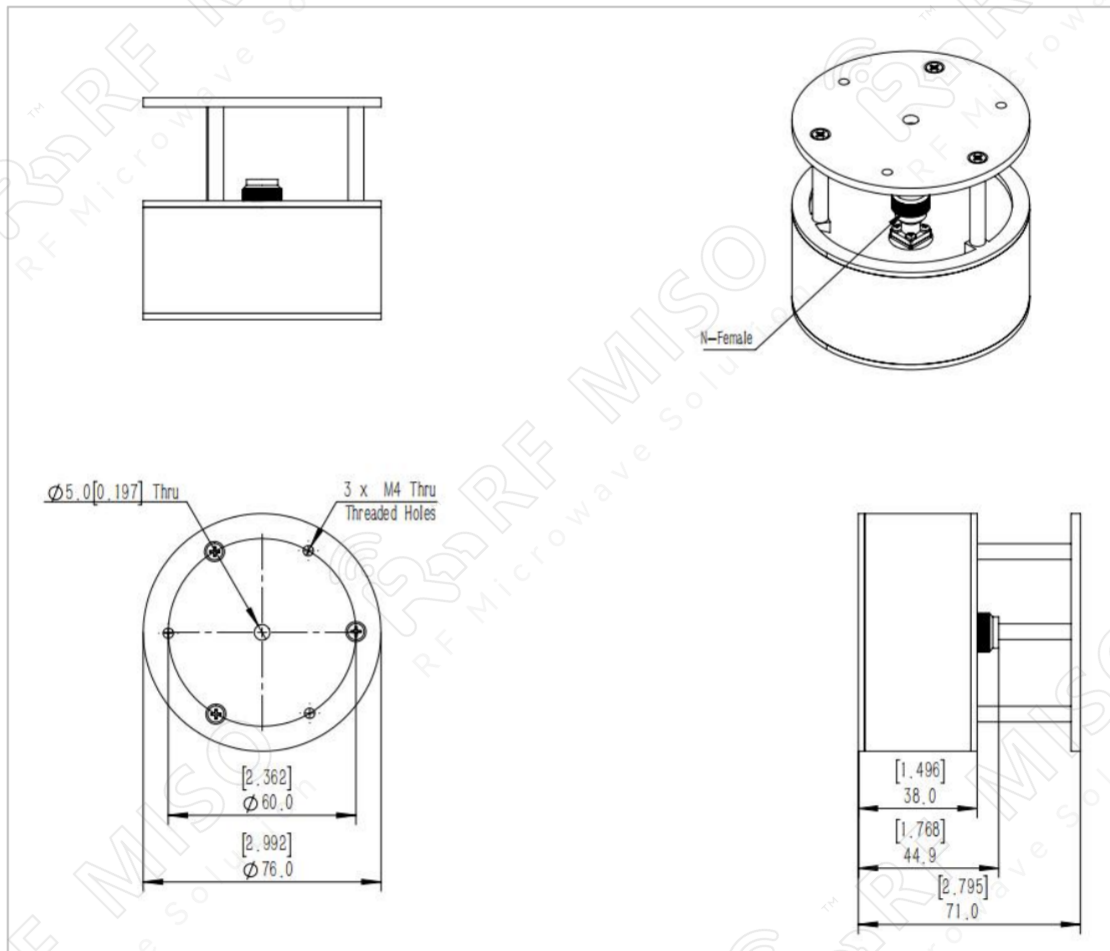



Ku band Omni-Directional Antenna
4 dBi Typ. Gain, 10.7-14.5GHz Frequency Range

Bi-conical Antenna Data Sheet

RM-BCA107145-4

Simulation Date

VSWR

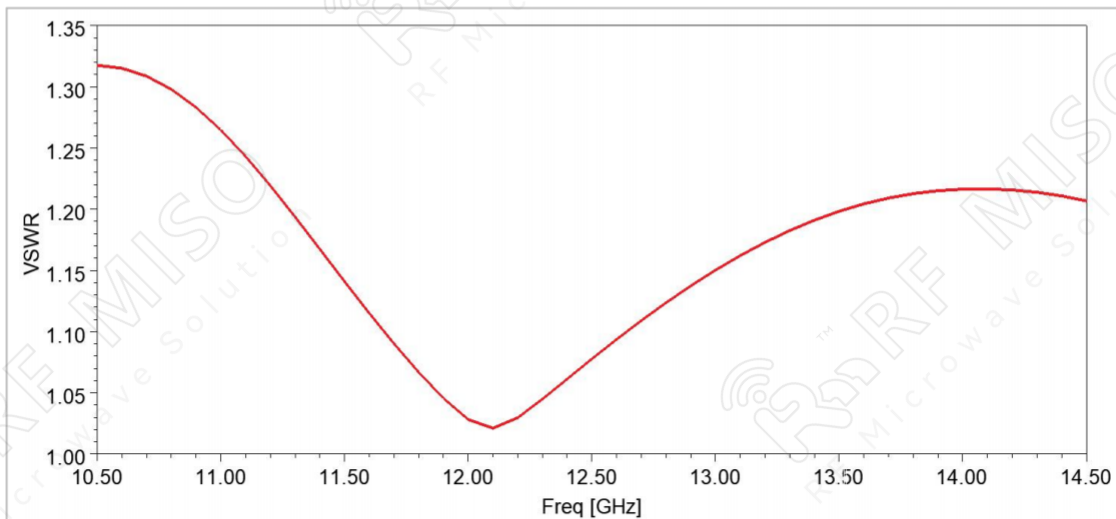
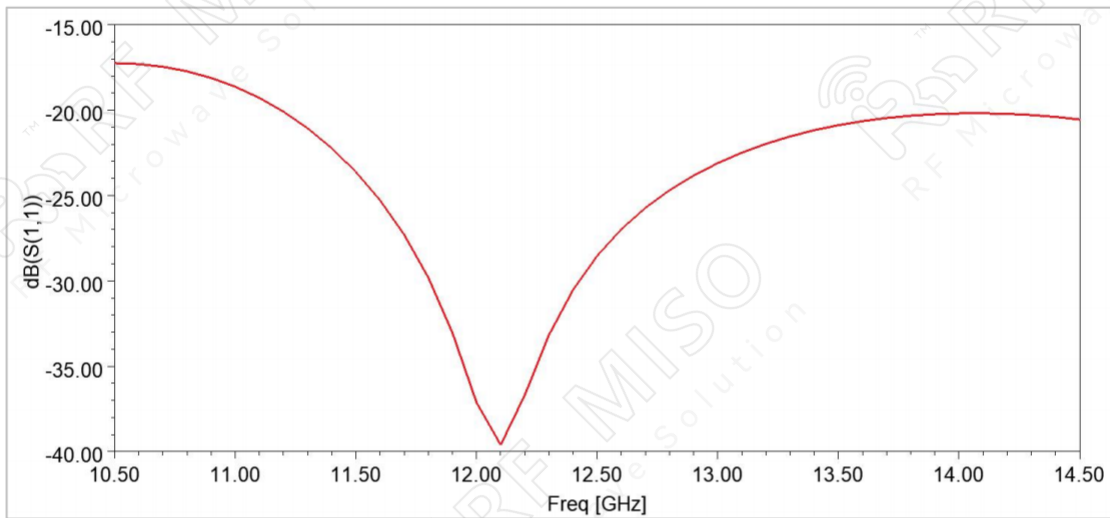



Ku band Omni-Directional Antenna
4 dBi Typ. Gain, 10.7-14.5GHz Frequency Range

Bi-conical Antenna Data Sheet

RM-BCA107145-4

Gain

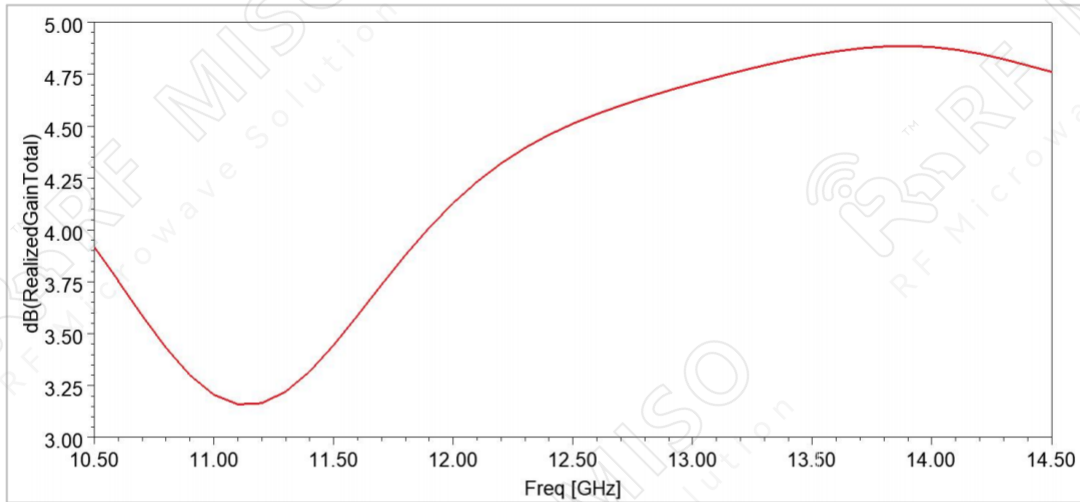

Gain Pattern

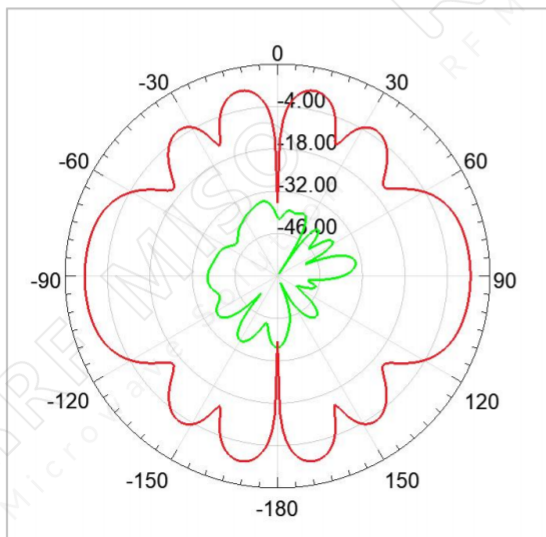

10.7 GHz

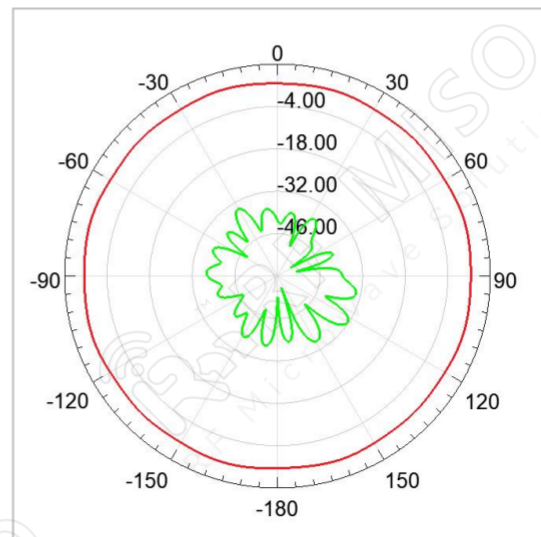

10.7 GHz



Ku band Omni-Directional Antenna
4 dBi Typ. Gain, 10.7-14.5GHz Frequency Range

Bi-conical Antenna Data Sheet

RM-BCA107145-4

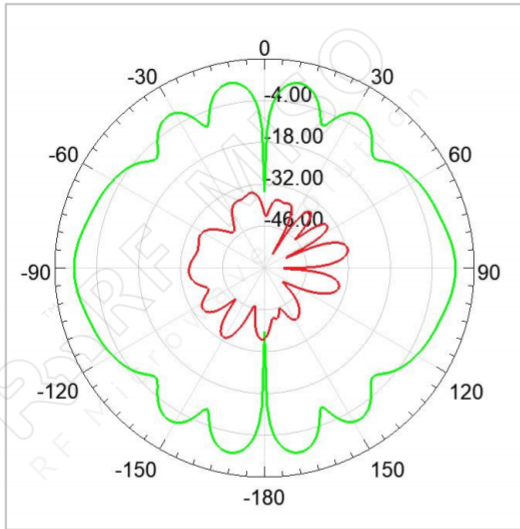

11.5 GHz

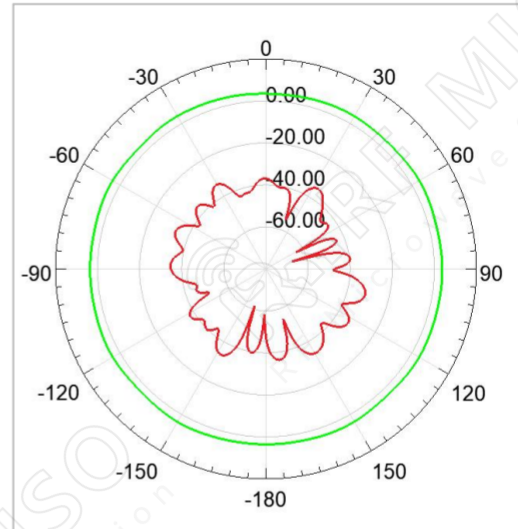

11.5 GHz

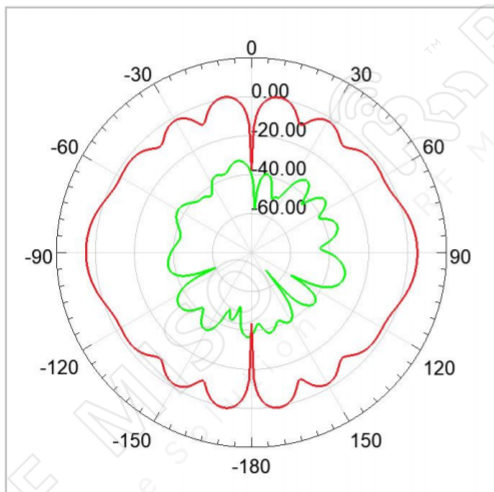

12.5 GHz

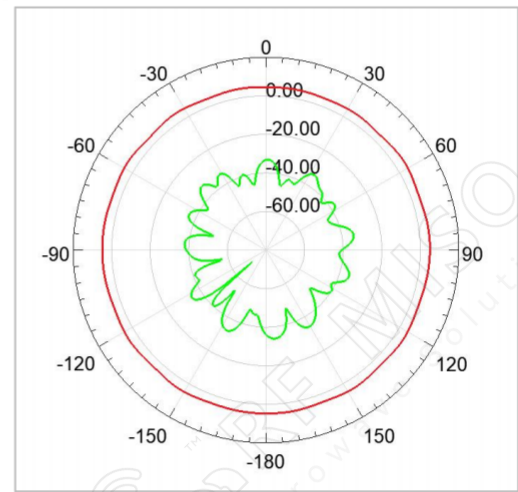

12.5 GHz



Ku band Omni-Directional Antenna
4 dBi Typ. Gain, 10.7-14.5GHz Frequency Range

Bi-conical Antenna Data Sheet

RM-BCA107145-4

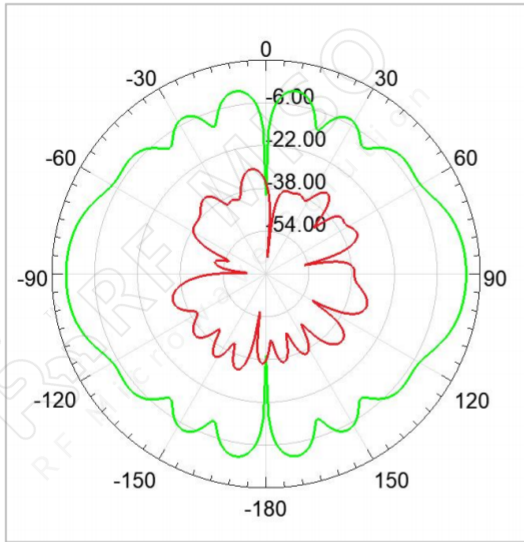

13.5 GHz

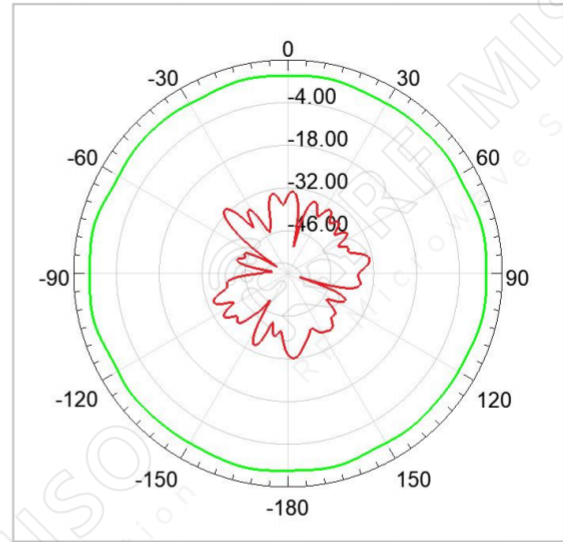

13.5 GHz

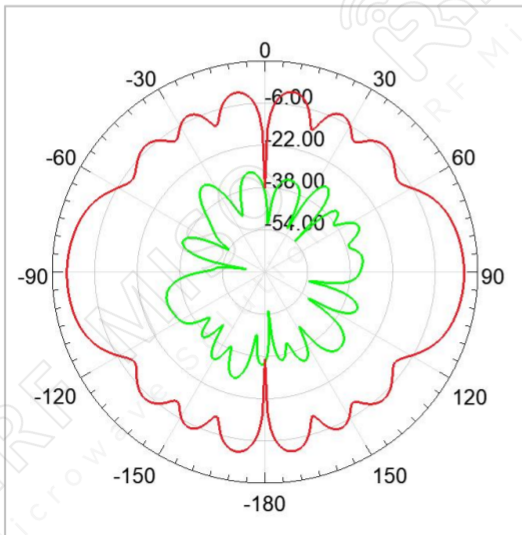

14.5 GHz

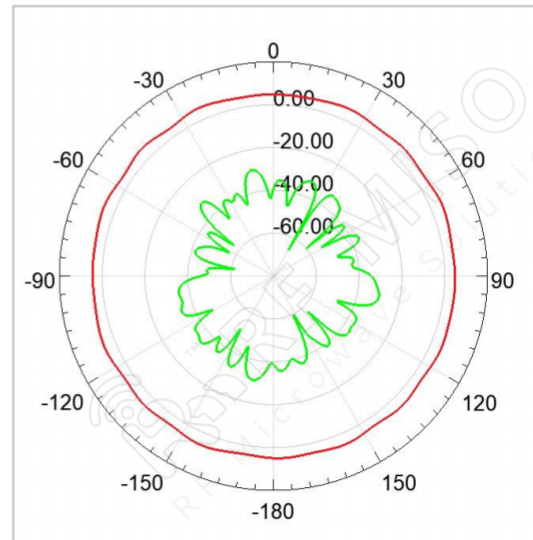

14.5 GHz