

Broadband Horn Antenna 20 dBi Typ. Gain, 2.9-3.6 GHz
Frequency Range

Broadband Horn Antenna Data Sheet

RM-BDHA2936-20

Specifications

RM-BDHA2936-20		
Parameters	Typical	Units
Frequency Range	2.9-3.6	GHz
Gain	20 Typ.	dBi
VSWR	1.1 Typ.	
Polarization	Linear	
Cross polarization	50	dB
Connector	N-Female	
Average Power	300	W
Peak Power	3000	W
Material	Al	
Size(L*W*H)	593.37*424*324(±5)	mm
Weight	<3	Kg

Broadband Horn Antenna 20 dBi Typ. Gain, 2.9-3.6 GHz Frequency Range

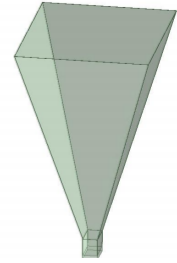

Broadband Horn Antenna Data Sheet

RM-BDHA2936-20

Outline Drawing

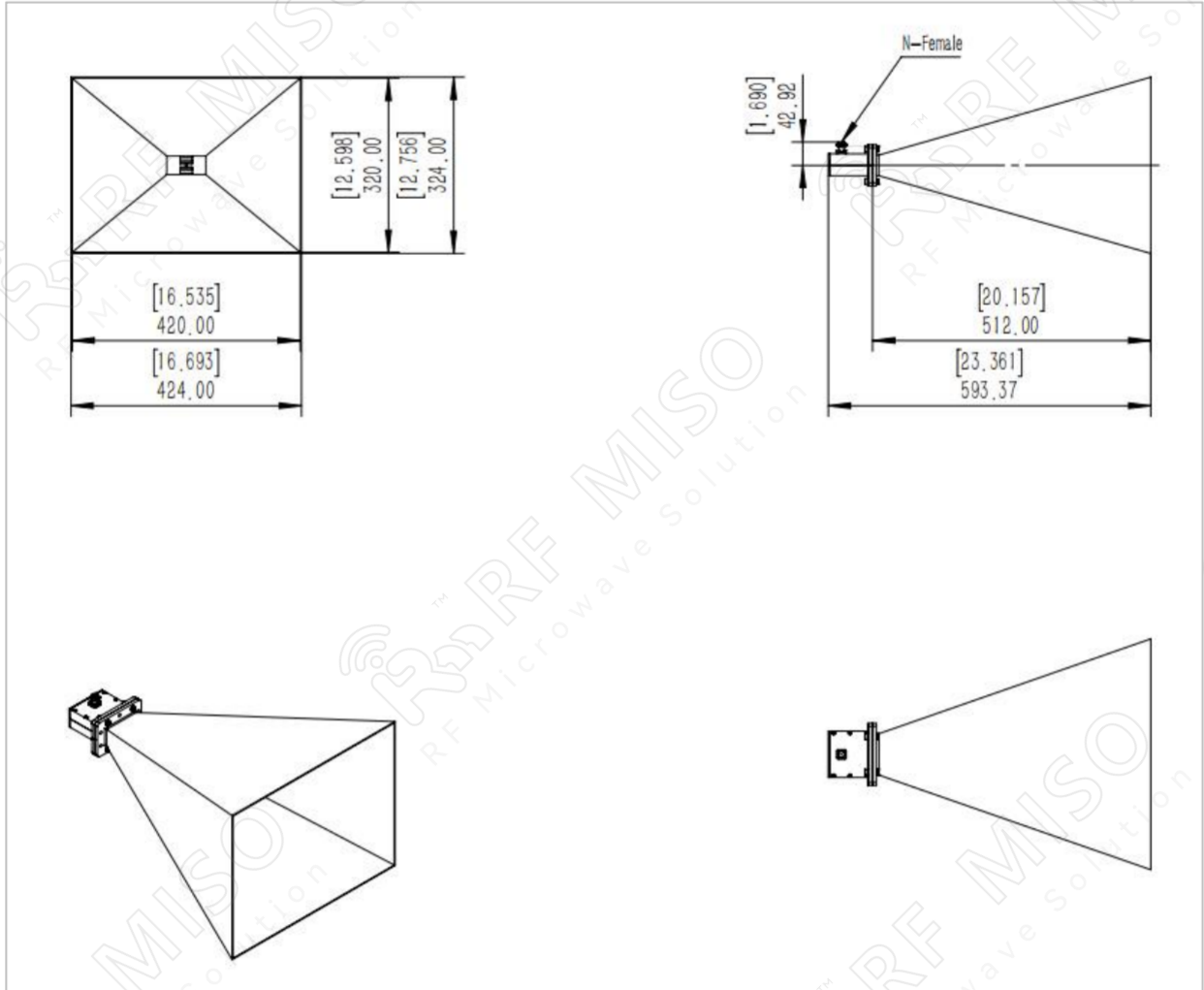

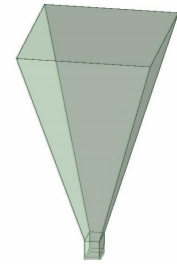

Broadband Horn Antenna 20 dBi Typ. Gain, 2.9-3.6 GHz
Frequency Range

Broadband Horn Antenna Data Sheet

RM-BDHA2936-20

Simulation Data

VSWR

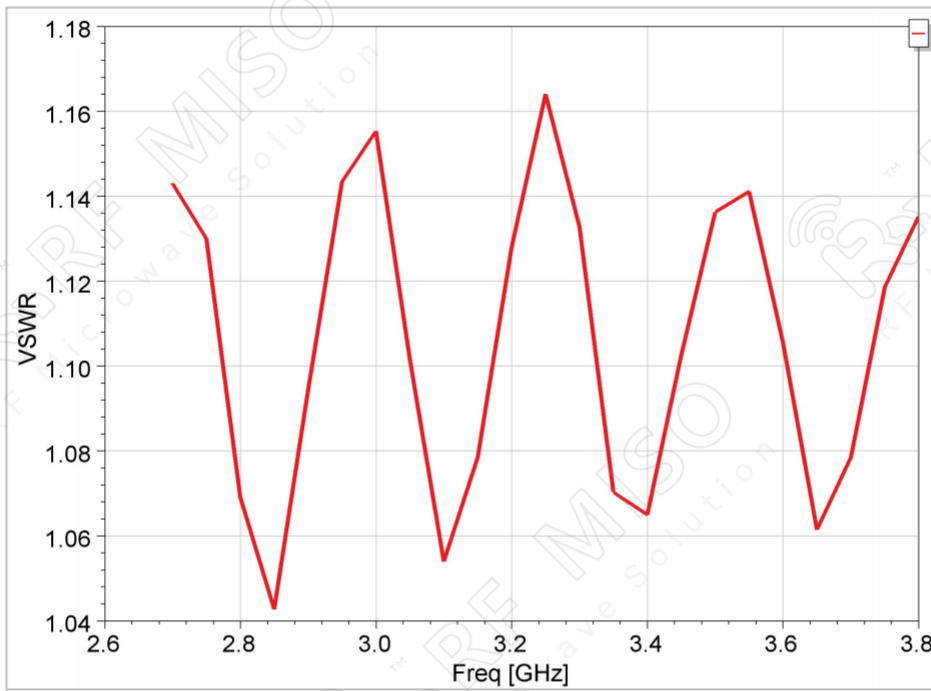

Gain

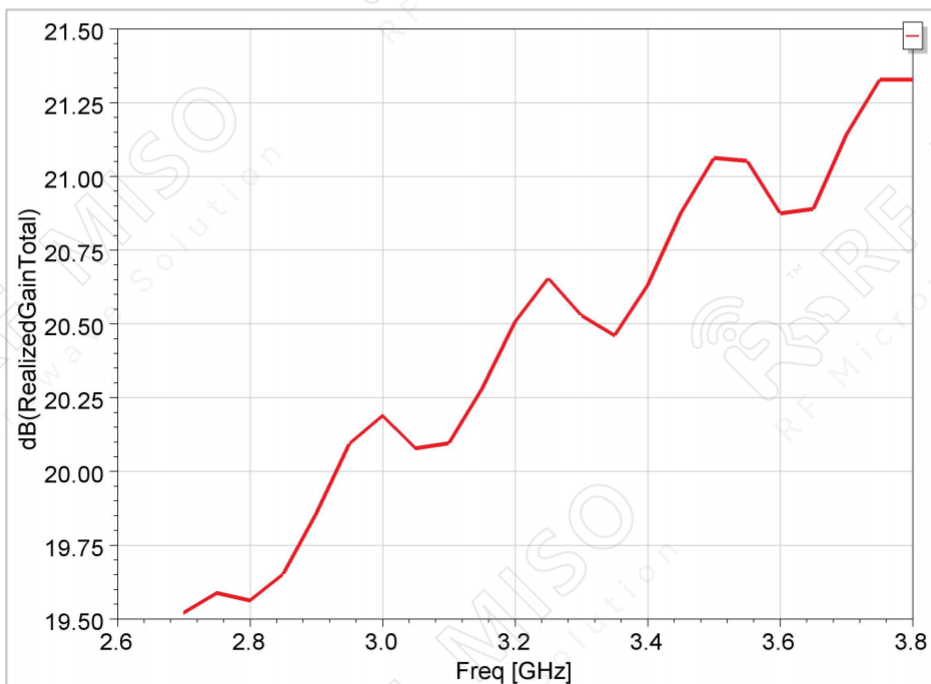

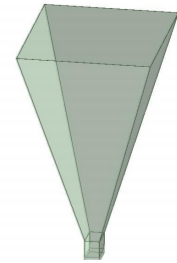

Broadband Horn Antenna 20 dBi Typ. Gain, 2.9-3.6 GHz Frequency Range

Broadband Horn Antenna Data Sheet

RM-BDHA2936-20

Cross Polarization

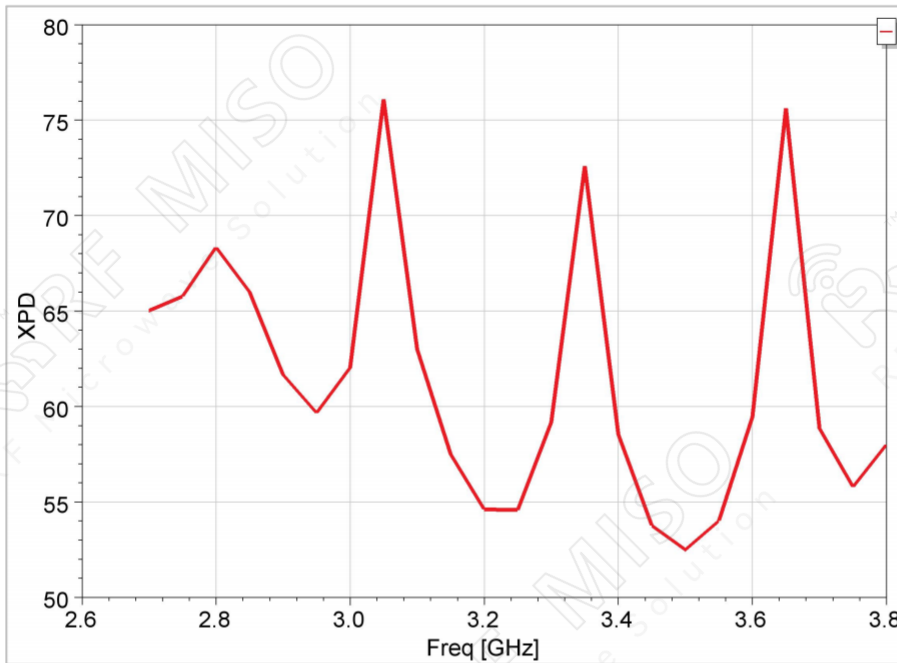

Pattern

2.8GHz

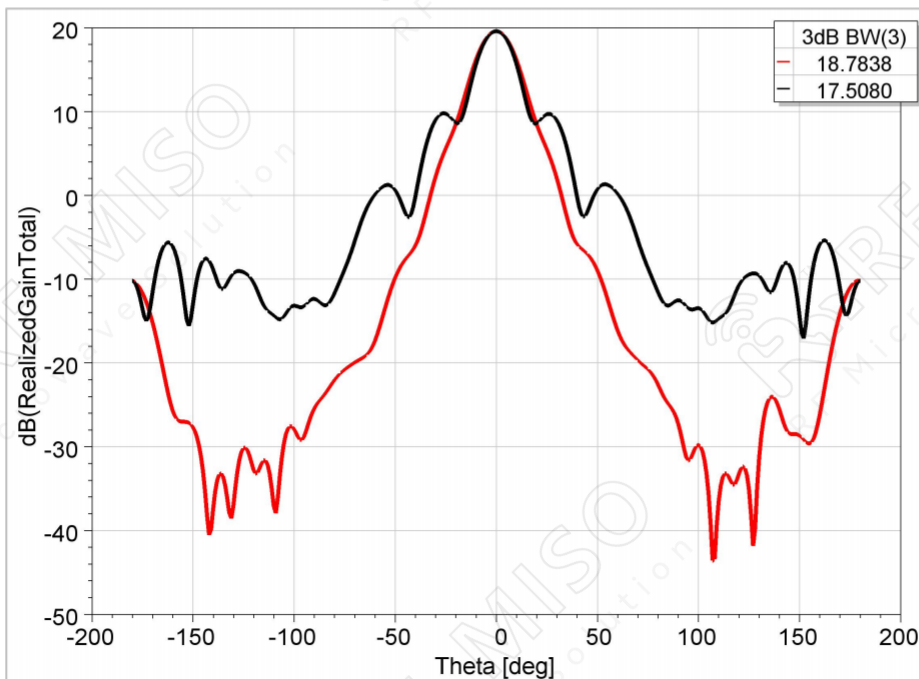

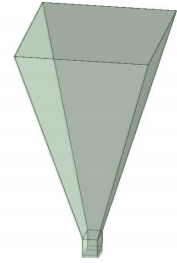

Broadband Horn Antenna 20 dBi Typ. Gain, 2.9-3.6 GHz Frequency Range

Broadband Horn Antenna Data Sheet

RM-BDHA2936-20

3.2GHz

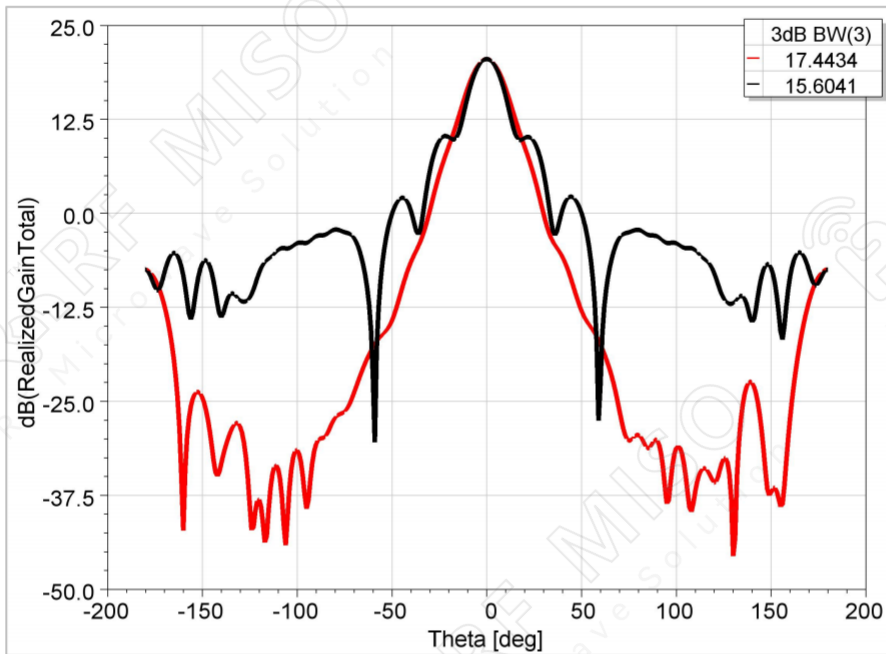

3.6GHz

