



*Circularly Polarized Horn Antenna 20dBi Typ. Gain,
8.2-12.4 GHz Frequency Range*

Circularly Polarized Horn Antenna Data Sheet

RM-CPHA82124-20

Features

- Low VSWR
- High Power handling
- Symmetrical Plane Beamwidth
- RHCP and LHCP
- Military Airborne Applications

Descriptions

RF MISO' s Model RM-CPHA82124-20 is RHCP and LHCP circularly polarized horn antenna that operates from 8.2 to 12.4GHz. The antenna offers a typical gain of 20 dBi and low VSWR 1.5 Typ.

The antenna is equipped with a circular polarizer, a Ortho-mode Transducer and a conical horn antenna. The gain of the antenna is uniform in the entire frequency band, the pattern is symmetrical, and the working efficiency is high. Antennas are widely used in antenna far-field testing, radio frequency radiation testing and other scenarios.

Specifications

RM-CPHA82124-20		
Parameters	Specification	Unit
Frequency Range	8.2-12.4	GHz
Gain	20 Typ.	dBi
VSWR	1.5 Typ.	
AR	1.3 Typ	dB
Polarization	RHCP and LHCP	
Interface	SMA-Female	
Material	Al	
Finishing	Paint	
Average Power	50	W
Peak Power	3000	W
Size (L*W*H)	505.2*164.9*182.8 (±5)	mm
Weight	0.888	kg



Circularly Polarized Horn Antenna 20dBi Typ. Gain,
8.2-12.4 GHz Frequency Range

Circularly Polarized Horn Antenna Data Sheet

RM-CPHA82124-20

Outline Drawing

N type and 2.92mm type connectors are available, please contact RF Miso.

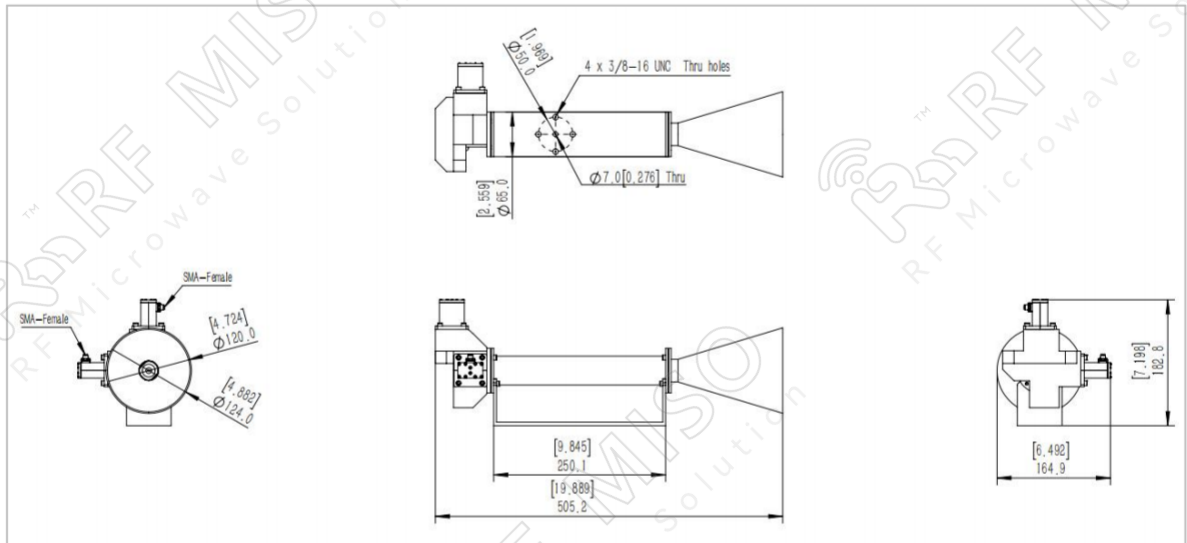

Simulation Data

Gain

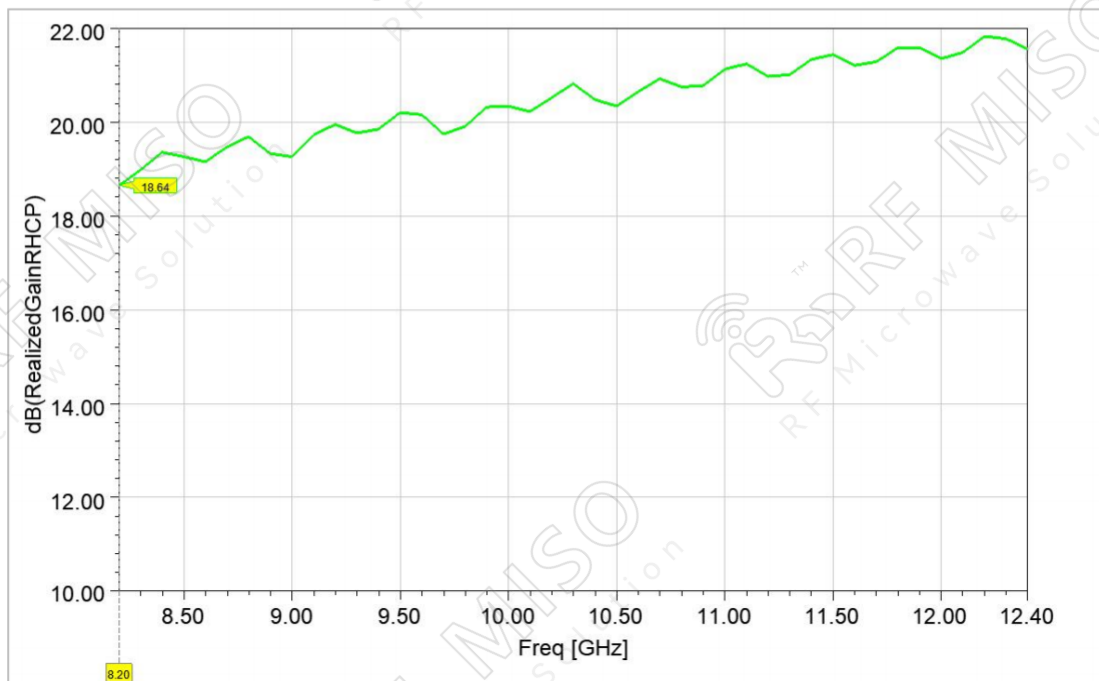



Circularly Polarized Horn Antenna 20dBi Typ. Gain,
8.2-12.4 GHz Frequency Range

Circularly Polarized Horn Antenna Data Sheet

RM-CPHA82124-20

VSWR

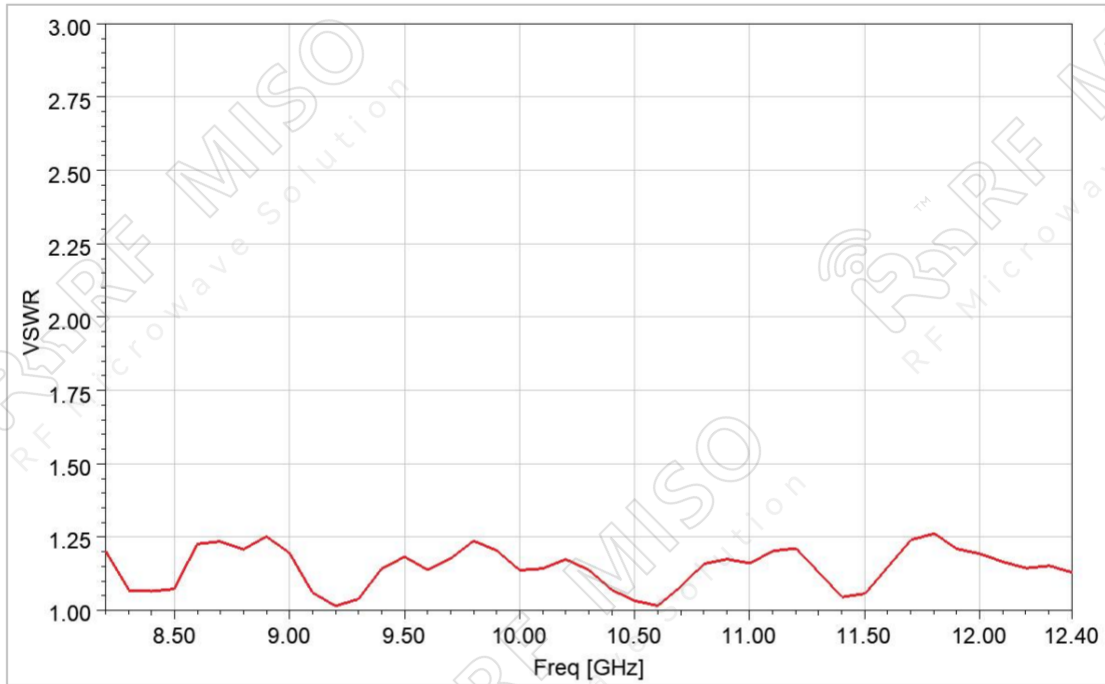

AR

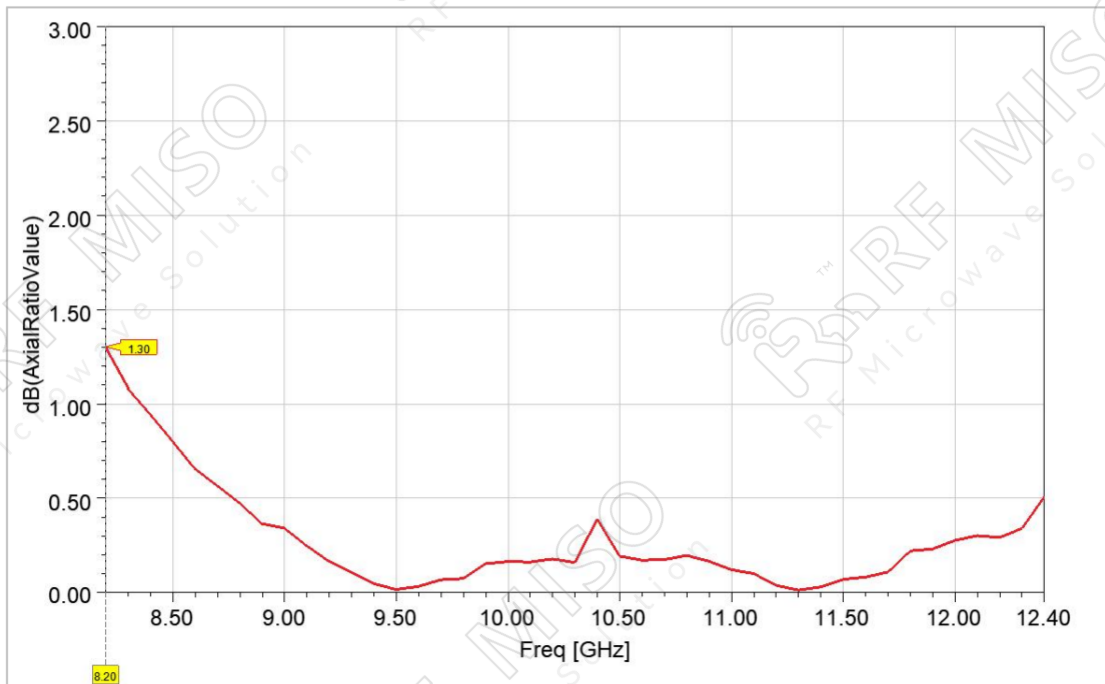



Circularly Polarized Horn Antenna 20dBi Typ. Gain,
8.2-12.4 GHz Frequency Range

Circularly Polarized Horn Antenna Data Sheet

RM-CPHA82124-20

Gain Plot

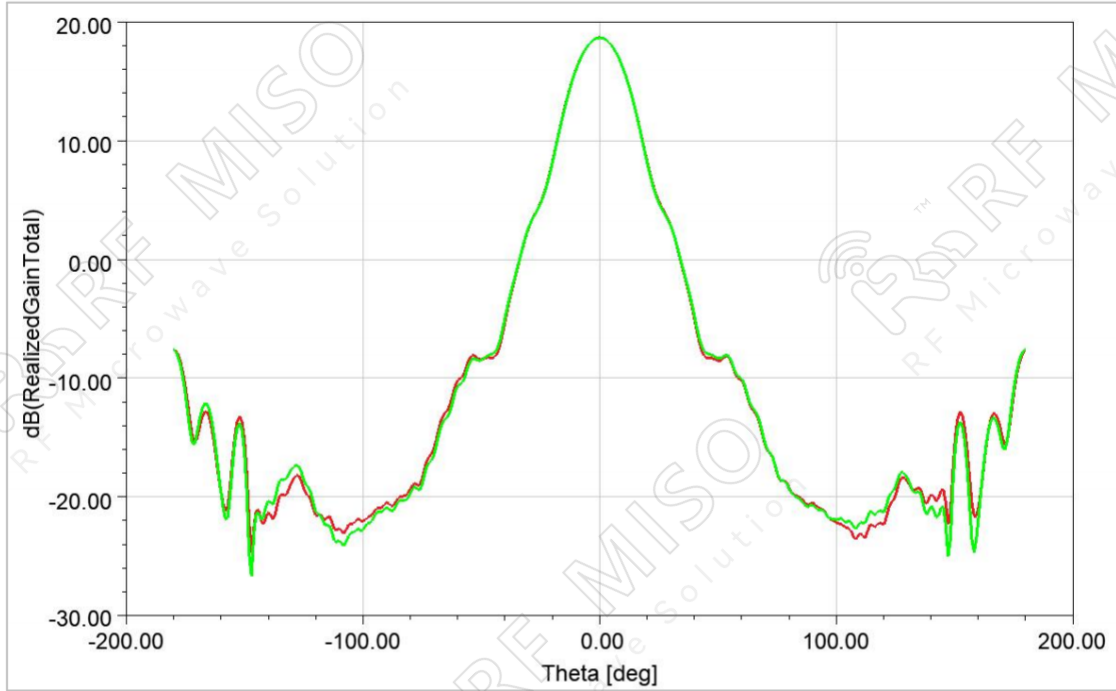

8.2GHz

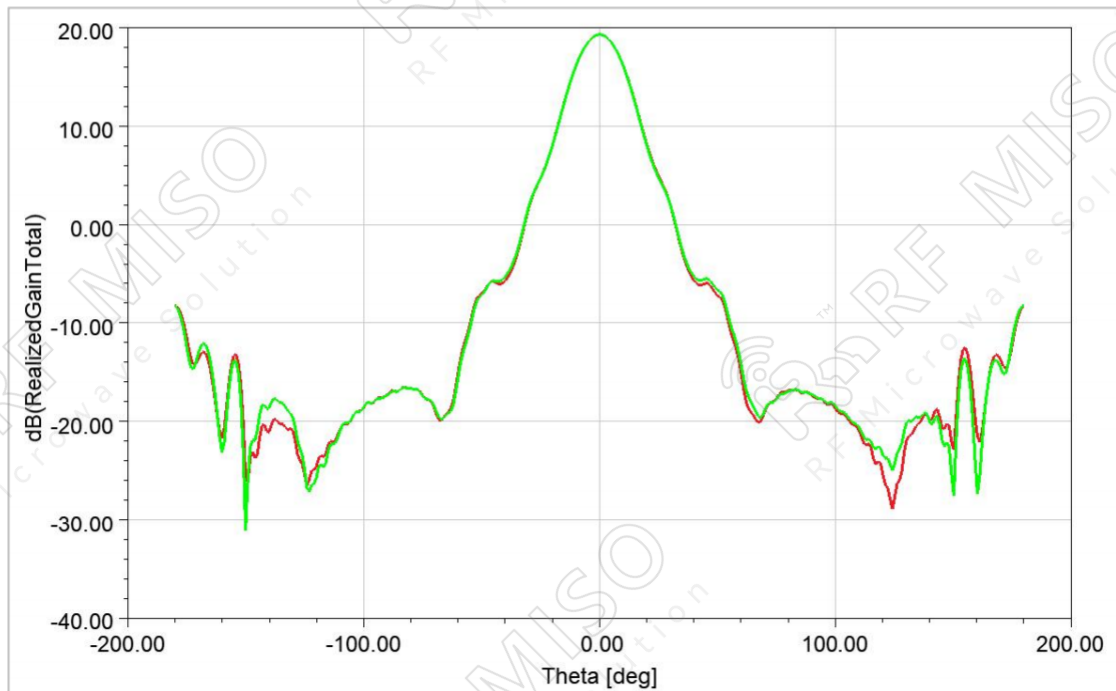

9GHz



Circularly Polarized Horn Antenna 20dBi Typ. Gain,
8.2-12.4 GHz Frequency Range

Circularly Polarized Horn Antenna Data Sheet

RM-CPHA82124-20

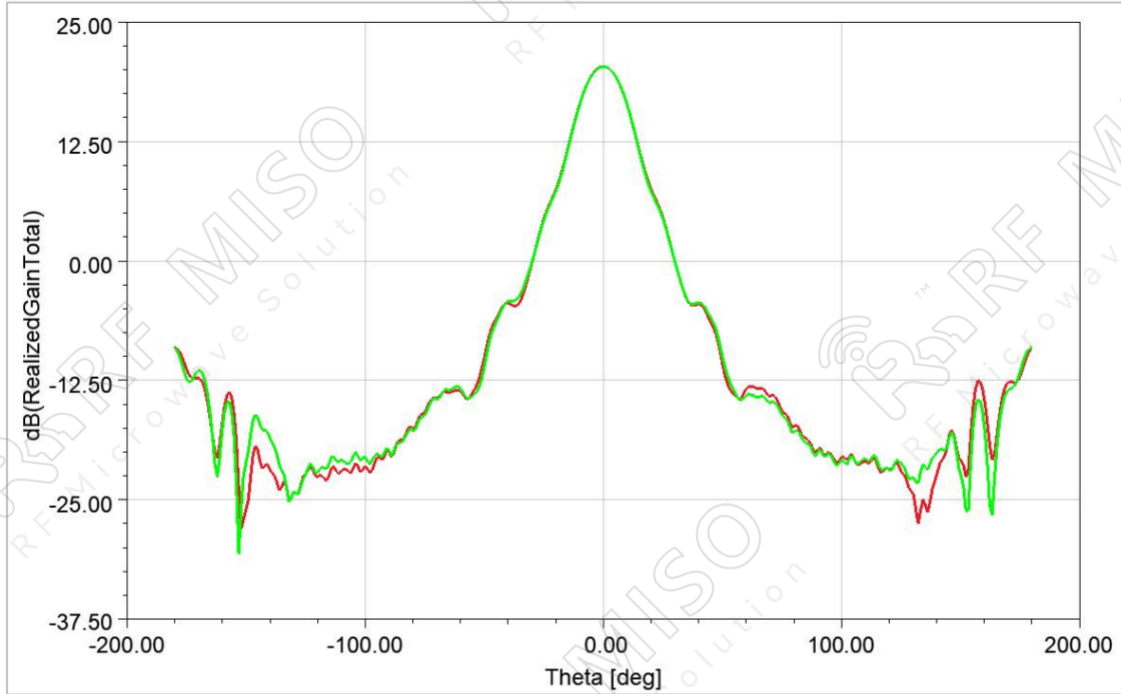

10GHz

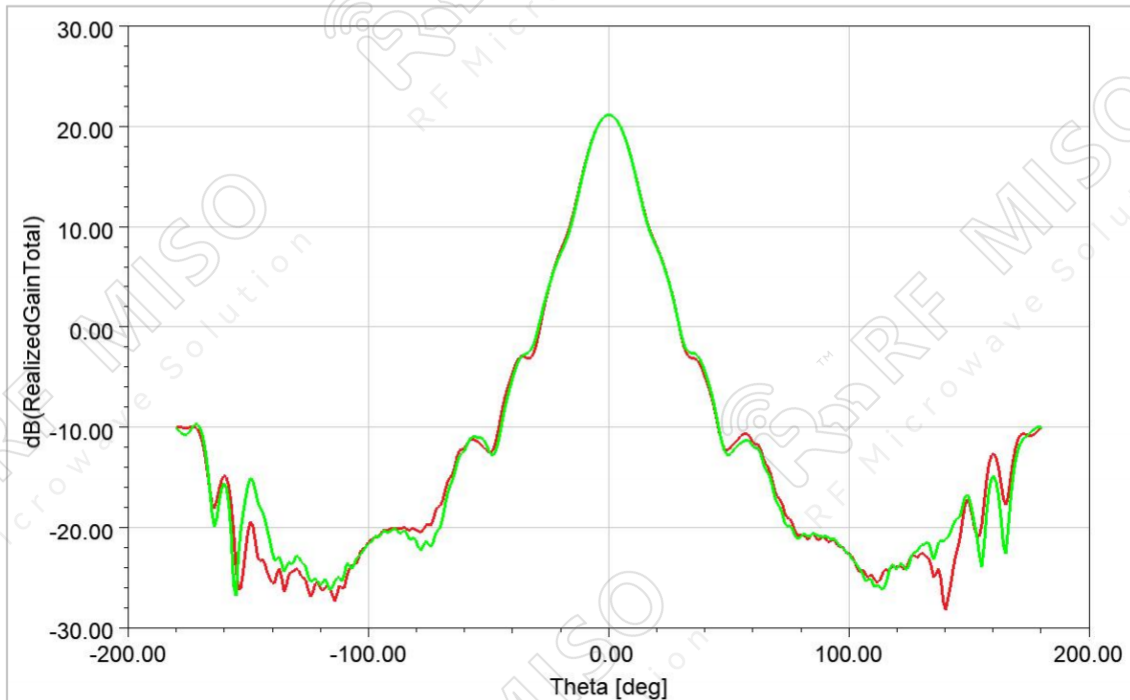

11GHz



Circularly Polarized Horn Antenna 20dBi Typ. Gain,
8.2-12.4 GHz Frequency Range

Circularly Polarized Horn Antenna Data Sheet

RM-CPHA82124-20

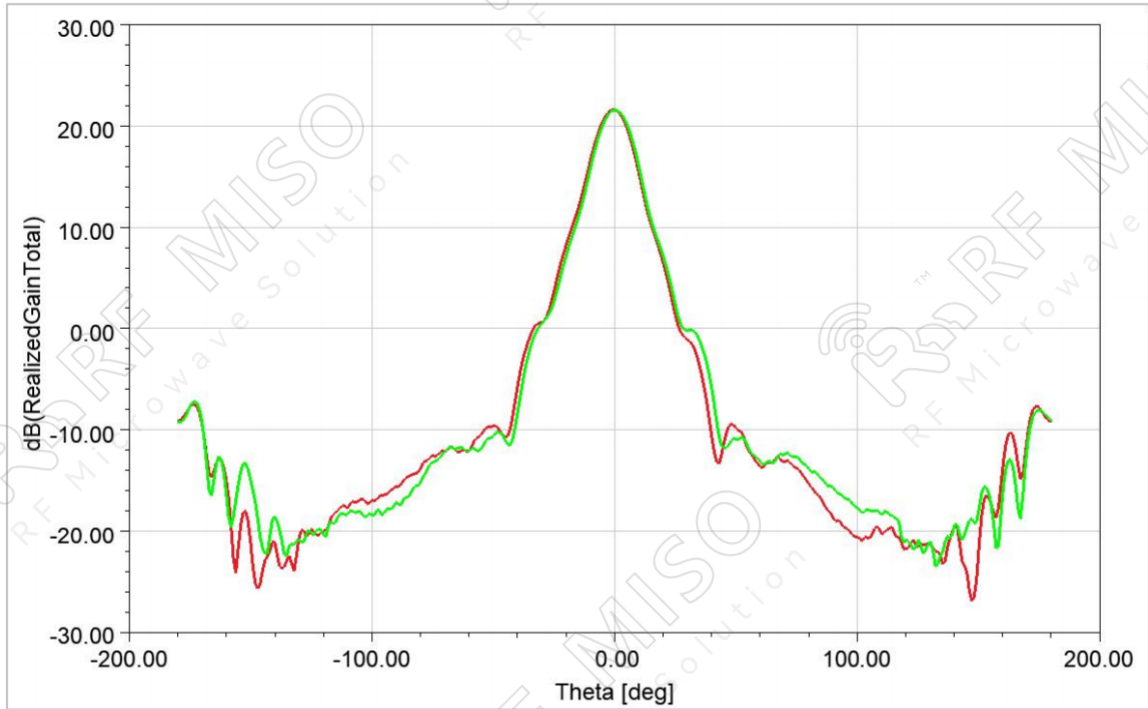

12.4GHz